

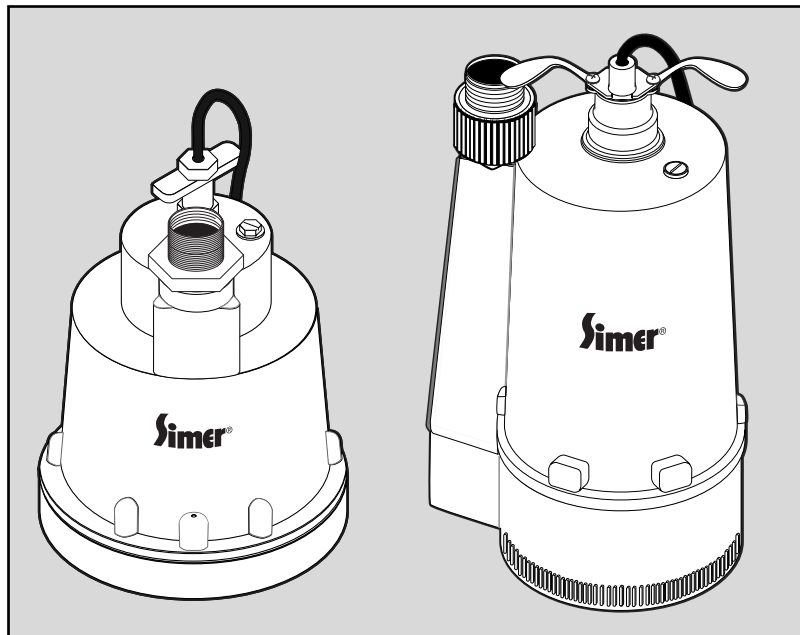

OWNER'S MANUAL
Submersible Utility Pumps

293 Wright St., Delavan, WI 53115
Phone: 1-800-468-7867
1-800-546-7867
Fax: 1-800-390-5351
Web Site: <http://www.simerpump.com>



**MOD. 2300, 2305, 2305G,
2310, 2355**

Installation/Operation/Parts

*For further operating, installation,
or maintenance assistance:*

Call 1-800-468-7867

English Pages 2-5

READ AND FOLLOW SAFETY INSTRUCTIONS!

Carefully read and follow all safety instructions in this manual and on pump.

⚠ This is the safety alert symbol. When you see this symbol on your pump or in this manual, look for one of the following signal words and be alert to the potential for personal injury.

⚠ DANGER warns about hazards that **will** cause serious personal injury, death or major property damage if ignored.

⚠ WARNING warns about hazards that **can** cause serious personal injury, death or major property damage if ignored.

⚠ CAUTION warns about hazards that **will** or **can** cause minor personal injury or property damage if ignored.

The label **NOTICE** indicates special instructions which are important but not related to hazards.

Keep safety labels in good condition.

Replace missing or damaged safety labels.

DESCRIPTION

These Submersible Utility Pumps are designed for draining water from basement floors, stock tanks, window wells, boats, flat roofs and cisterns. The units are equipped with a 3-prong grounding-type power cord. The shaded-pole motors are oil filled and sealed for cooler operation. The sleeve bearings on the motor shaft never need lubrication. Automatic reset thermal protection.

SPECIFICATIONS

Power supply required.....115V, 60 HZ.
 Motor dutycontinuous
 Liquid Temp. Range Less Than 120°F (50°C)
 Individual Branch Circuit Required (min.).....15 Amps
 Discharge:.....1-1/4" NPT

⚠ WARNING Risk of fire or explosion. Do not use in explosive atmospheres. **Pump water only with this pump.**

PERFORMANCE

GPH (LPH) AT TOTAL FEET (M)						
Model No.	0 (0)	5 (1.5m)	10 (3m)	15 (4.6m)	20 (6.1m)	25 (7.6m)
CAPACITY GALLONS(L)/Hour						
2300	1,260	1,140	1,120	840	480	–
C2300	(4,740)	(4,320)	(3,840)	(3,180)	(1,800)	(–)
2305	1,260	1,140	1,120	840	480	–
	(4,740)	(4,320)	(3,840)	(3,180)	(1,800)	(–)
2305G	1,260	1,140	1,120	840	480	–
	(4,740)	(4,320)	(3,840)	(3,180)	(1,800)	(–)
2310	1,260	1,140	1,120	840	480	–
C2310	(4,740)	(4,320)	(3,840)	(3,180)	(1,800)	(–)
2355	2,160	1,740	1,620	1,260	720	60
C2355	(8,160)	(6,600)	(6,120)	(4,790)	(2,700)	(240)

Simer Limited Warranty

SIMER warrants to the original consumer purchaser ("Purchaser") of its products that they are free from defects in material or workmanship.

If within twelve (12) months from the date of the original consumer purchase any such product shall prove to be defective, it shall be repaired or replaced at SIMER's option, subject to the terms and conditions set forth below. Your original receipt of purchase is required to determine warranty eligibility.

Exceptions to the Twelve (12) Month Warranty

Ninety (90) Day Warranty:

If within ninety (90) days from original consumer purchase any Drill Pump or MiniVac Pump shall prove to be defective, it shall be replaced, subject to the terms set forth below.

Two (2) Year Warranty:

If within two (2) years from original consumer purchase, any 1/3 HP Submersible Sump Pump, or Models 2330, 2300 or A5500, shall prove to be defective, it shall be repaired or replaced at SIMER's option, subject to the terms and conditions set forth below.

Three (3) Year Warranty:

If within three (3) years from original consumer purchase any 4" Submersible Well Pump, 1/2 HP Submersible Sump Pump, or Booster Pump Model 3075SS shall prove to be defective, it shall be repaired or replaced at SIMER's option, subject to the terms and conditions set forth below.

Five (5) Year Warranty:

If within five (5) years from original consumer purchase any Pre-Charge water system tank shall prove to be defective, it shall be repaired or replaced at SIMER's option, subject to the terms and conditions set forth below.

General Terms and Conditions

Purchaser must pay all labor and shipping charges necessary to replace product covered by this warranty. This warranty shall not apply to acts of God, nor shall it apply to products which, in the sole judgement of SIMER, have been subject to negligence, abuse, accident, misapplication, tampering, alteration; nor due to improper installation, operation, maintenance or storage; nor to other than normal application, use or service, including but not limited to, operational failures caused by corrosion, rust or other foreign materials in the system, or operation at pressures in excess of recommended maximums.

Requests for service under this warranty shall be made by returning the defective product to the Retail outlet or to SIMER as soon as possible after the discovery of any alleged defect. SIMER will subsequently take corrective action as promptly as reasonably possible. No requests for service under this warranty will be accepted if received more than 30 days after the term of the warranty.

This warranty sets forth SIMER's sole obligation and purchaser's exclusive remedy for defective products.

SIMER SHALL NOT BE LIABLE FOR ANY CONSEQUENTIAL, INCIDENTAL, OR CONTINGENT DAMAGES WHATSOEVER.

THE FOREGOING WARRANTIES ARE EXCLUSIVE AND IN LIEU OF ALL OTHER EXPRESS WARRANTIES. IMPLIED WARRANTIES, INCLUDING BUT NOT LIMITED TO THE IMPLIED WARRANTIES OF MERCHANTABILITY AND FITNESS FOR A PARTICULAR PURPOSE, SHALL NOT EXTEND BEYOND THE DURATION OF THE APPLICABLE EXPRESS WARRANTIES PROVIDED HEREIN.

Some states do not allow the exclusion or limitation of incidental or consequential damages or limitations on how long an implied warranty lasts, so the above limitations or exclusions may not apply to you. This warranty gives you specific legal rights and you may also have other rights which vary from state to state.

SIMER • 293 Wright Street • Delavan, WI U.S.A. 53115
Phone: 1-800-468-7867 / 1-800-546-7867 • Fax: 1-800-390-5351
Email: info@simerwater.com • Web: http://www.simerwater.com

For parts or assistance, call Simer Customer Service at 1-800-468-7867 / 1-800-546-7867

ELECTRICAL & SWITCH SPECIFICATIONS

Model No.	Motor HP	Motor Full Load Amps	Individual Branch Circuit Req. (Amps)
2300, C2300	1/6	5.6	10
2305	1/6	6.0	10
2305G	1/6	6.0	10
2310, C2310	1/6	5.6	10
2355, C2355	3/10	10.0	15

GENERAL SAFETY INFORMATION

Electrically powered utility pumps normally give many years of trouble-free service when correctly installed, maintained, and used. See the "Troubleshooting Chart" in this manual for information about common utility pump problems and remedies. For more information, see your retailer, or call Simer customer service at 1-800-468-7867 or 1-800-546-7867.

1. Know the pump application, limitations, and potential hazards.
2. **Do not use in water where fish are present.**
3. Disconnect the power before servicing.
4. Release all the pressure within the system before servicing any component.
5. Drain all the water from the system before servicing.
6. Secure the discharge line before starting the pump. An unsecured discharge line will whip, possibly causing personal injury and/or property damage.
7. Check hoses for a weak or worn condition before each use, making certain that all connections are secure.
8. Periodically inspect the pump and the system components. Keep free of debris and foreign objects. Perform routine maintenance as required.
9. Provide a means of pressure relief for pumps whose discharge line can be shut-off or obstructed.
10. Personal Safety:
 - a. Wear safety glasses at all times when working with pumps.
 - b. Keep work area clean, uncluttered and properly lighted – replace all unused tools and equipment.
 - c. Keep visitors at a safe distance from work area.
 - d. Make workshop child-proof – with padlocks, master switches, and by removing starter keys.
11. When wiring an electrically driven pump, follow all of the electrical and safety codes that apply.
12. **This equipment is only for use on 115 volt (single phase) and is equipped with an approved 3-conductor cord and 3-prong, grounding-type plug.**

⚠ WARNING Hazardous voltage. Can shock, burn or cause death. To reduce the risk of electric shock, pull the plug before servicing. This pump has not been investigated for use in swimming pool areas. The pump is supplied with a grounding conductor and grounding-type attachment plug. Be sure it is connected only to a properly grounded grounding-type receptacle.

Where a 2-prong wall receptacle is encountered, it must be replaced with properly grounded 3-prong receptacle installed in accordance with the codes and ordinances that apply.

Do not walk on wet area until all power has been turned off. If the shut-off box is in the basement, call the electric company or hydro authority to shutoff the service to house, or call your local fire department for instructions. Failure to follow this warning can result in a fatal electrical shock.

Do not lift the pump by the power cord.

13. All wiring should be performed by a qualified electrician.
14. Make certain the power source conforms to the requirements of your equipment.
15. Protect the electrical cord from sharp objects, hot surfaces, oil, and chemicals. Avoid kinking the cord. Replace or repair damaged or worn cords immediately.
16. Do not touch an operating motor. Modern motors are designed to operate at high temperatures.
17. Do not handle the pump or the pump motor, or change fuses with wet hands or when standing on wet or damp surface, or in water.

INSTALLATION

1. Set the pump on a hard surface in at least 2 inches of water.
2. Connect the discharge line with the fittings provided.
3. The pump should not be installed on clay, dirt, mud or sand surfaces. Although the pump will usually pass small particles suspended in water, clean the area to be pumped of small stones and gravel which could clog the pump.

***NOTICE:** Grass, mud, sand or pea gravel can clog the pump and reduce it's performance. Keep the pump inlet screen clean.

4. To reduce motor noise and vibrations when using rigid pipe, a short length of rubber hose (e.g. radiator hose) can be connected into the discharge line near the pump using suitable clamps.
5. Power Supply: These pumps are designed for 115 V., 60 Hz., operation and requires a minimum 15 amp individual branch circuit. Pump is supplied with a 3-wire cord with grounding-type plug.

▲WARNING **Hazardous voltage. Can shock, burn or cause death.** Pump should always be electrically grounded to a suitable electrical ground such as a grounded water pipe or a properly grounded metallic raceway, or ground wire system. Do not cut off round ground pin.

6. If the pump discharge line is exposed to an outside sub-freezing atmosphere, the portion of line exposed must be installed so any water remaining in the pipe will drain to the outfall by gravity. Failure to do this can cause the water trapped in the discharge to freeze which could result in damage to the pump.
7. Check the system operation by observing the pump operation through one complete cycle.

▲WARNING **Risk of flooding. Failure to make this operational check may lead to improper operation, premature failure, and flooding.**

OPERATION

▲WARNING **Hazardous voltage. Can shock, burn or cause death.** Do not handle a pump or pump motor with wet hands or when standing on wet or damp surface, or in water.

Before attempting to check why a unit has stopped operating, disconnect power from the unit.

1. The shaft seal depends on water for lubrication and cooling. Do not operate the pump unless it is submerged in water as seal may be damaged if allowed to run dry.
2. The pump will not remove all water. On a flat surface Model Nos. 2300, C2300, 2305, 2310, C2310 and 2305G will pump down to within 1/8" of the pumping surface. Model No. 2355 will pump down to within 5/8" of the pumping surface.

NOTICE: For continuous operation, the pump must be submerged to prevent the motor from overheating. A fully submerged pump is preferred for proper cooling when a pump runs continuously.

AIRLOCKS

When a pump airlocks, it runs but does not move any water. An airlock will cause the pump to overheat and fail. The -01 Series pumps have a built in anti-airlock hole. See the exploded view on the repair parts page for the location of the hole. Water leakage from the anti-airlock hole is normal.

If you suspect an airlock, unplug the pump, clean out the anti-airlock hole with a paper clip or a piece of wire, and restart the pump.

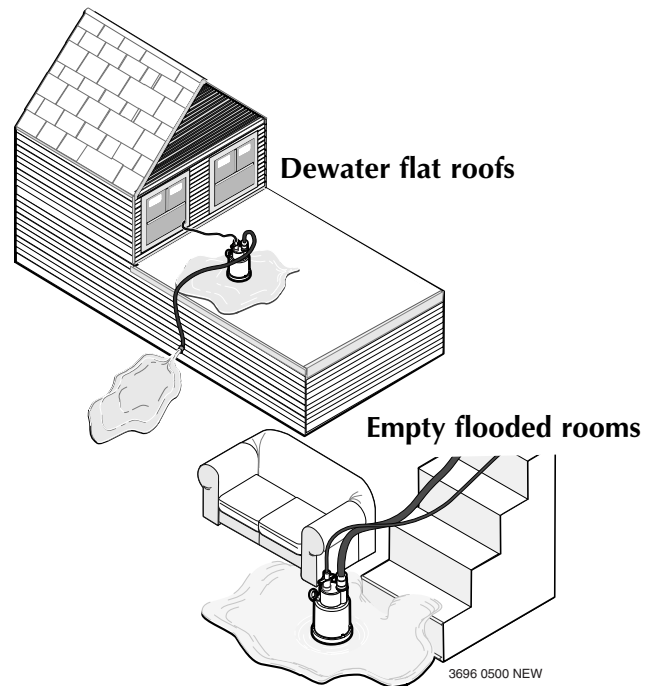

Troubleshooting

SYMPTOM	PROBABLE CAUSE(S)	CORRECTIVE ACTION
Pump won't start or run.	Pump is not plugged in. Blown fuse. Low line voltage. Defective motor.	Check and see if pump is plugged in to a proper outlet. If blown, replace with fuse of proper size or reset breaker. If voltage is under recommended minimum. Check size of wiring from main switch on property. If OK, contact power company or hydro authority. Replace pump.
Pump operates but delivers little or no water.	Restricted discharge (obstacle or ice in piping). Restricted intake. Low line voltage. Worn or plugged impeller. The anti-airlock hole is plugged.	Remove pump and clean pump and piping. Remove the pump and clean out the intake screen. The voltage is under recommended minimum. Check size of wiring from main switch on property. If OK, contact power company or hydro authority. Replace pump. Turn off the pump, clean out the anti-airlock hole, and restart the pump.

Model Numbers
2300-01, 2300-03, C2300-01,
2310-01, and C2310-01

Model Numbers
2305, 2305-03, 2305G,
2355, and C2355

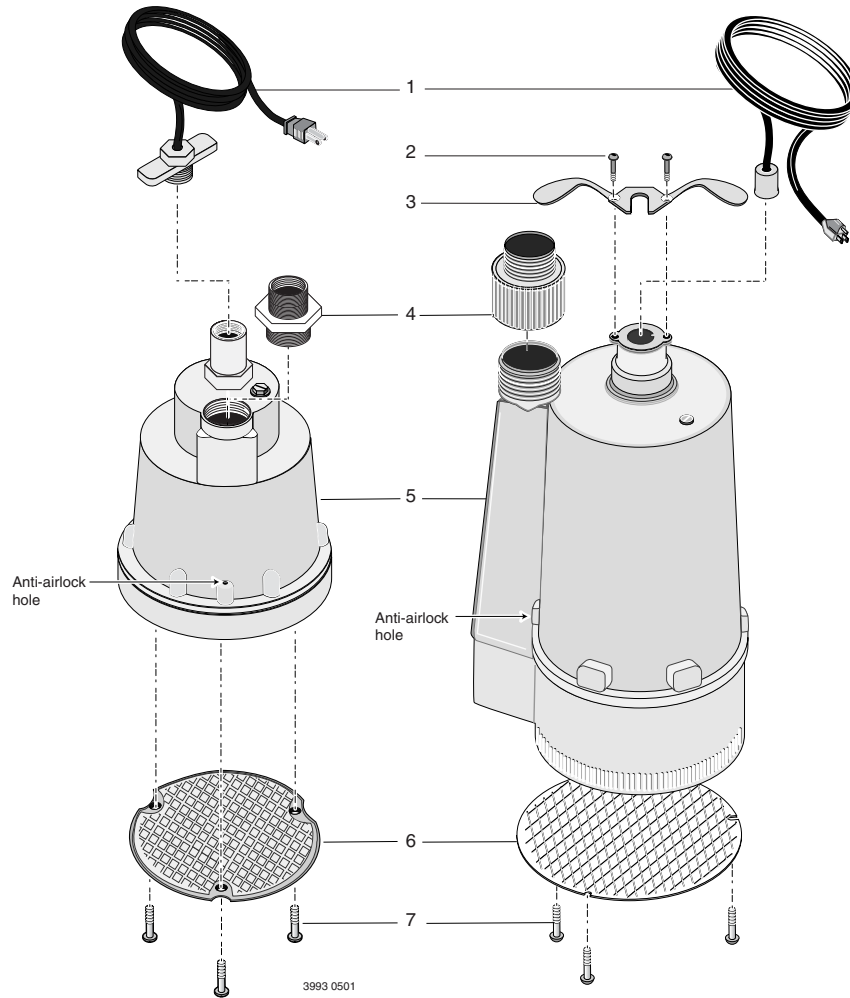

Key	Part Description	Qty.	2300-01	2305, 2305-03
			2300-03, C2300-01 2310-01, C2310-01	2305G 2355, C2355
1	Power Cord (2310, C2310, 2305G)	1	PS117-136-TSU	2911-B
1	Power Cord (2300, C2300, 2305, 2355)	1	PS117-54-TSU	227-264-B-TSU
1	Power Cord (C2305, C2355)	1	—	227-228-TSU
2	Screw, Handle	2	—	670-646
3	Handle	1	—	383-147-B
4	Adapter	1	007-031	007-022
5	Cover, Motor Assembly	1	**	**
6	Inlet Screen	1	667-016	667-013
7	Screws, Screen	3	670-793	670-646

** If the motor fails, replace the entire pump.