

EarthWay[®] EV-N-SPRED

ASSEMBLY and OPERATING INSTRUCTIONS
for

EarthWay EV-N-SPRED[®]

MODEL 2150

Broadcast Spreader rev 10-06

PLEASE CALL IF YOU ARE MISSING ANY PARTS, HAVE ANY DIFFICULTY IN ASSEMBLY, OR HAVE ANY QUESTIONS REGARDING THE SAFE OPERATION OF THIS SPREADER. THIS MODEL INCLUDES LIFETIME TECHNICAL SUPPORT
SUPPORT HOT LINE: 574-848-7491 or 800-294-0671
EMAIL: support@earthway.com

HELPFUL HINTS:

- If your spreader does not spread evenly, be sure the **FRONT** on the gear box points to the front of the spreader. The impeller must turn clockwise. Reversing the gearbox will cause the impeller to turn counter clockwise. Clean the impeller after each use as some fertilizer may become stuck on the impeller blades and will cause uneven spreading.
- Your spreader is designed to be pushed at three miles per hour, which is a brisk walking speed. Slower or faster speeds will change the spread patterns. Wet fertilizer will also change the spread pattern and flow rate. **Clean and dry** your spreader thoroughly after each use. Wash between the shut off plate and bottom of the hopper.
- Gears are permanently lubricated at the factory. Do not open the gearbox or dirt may enter.
- When using **Rock Salt** remove the agitator to prevent damage to the gearbox and remove salt from the hopper daily. **Rock Salt** will re-constitute back into a solid block over night with humidity and will damage your spreader.

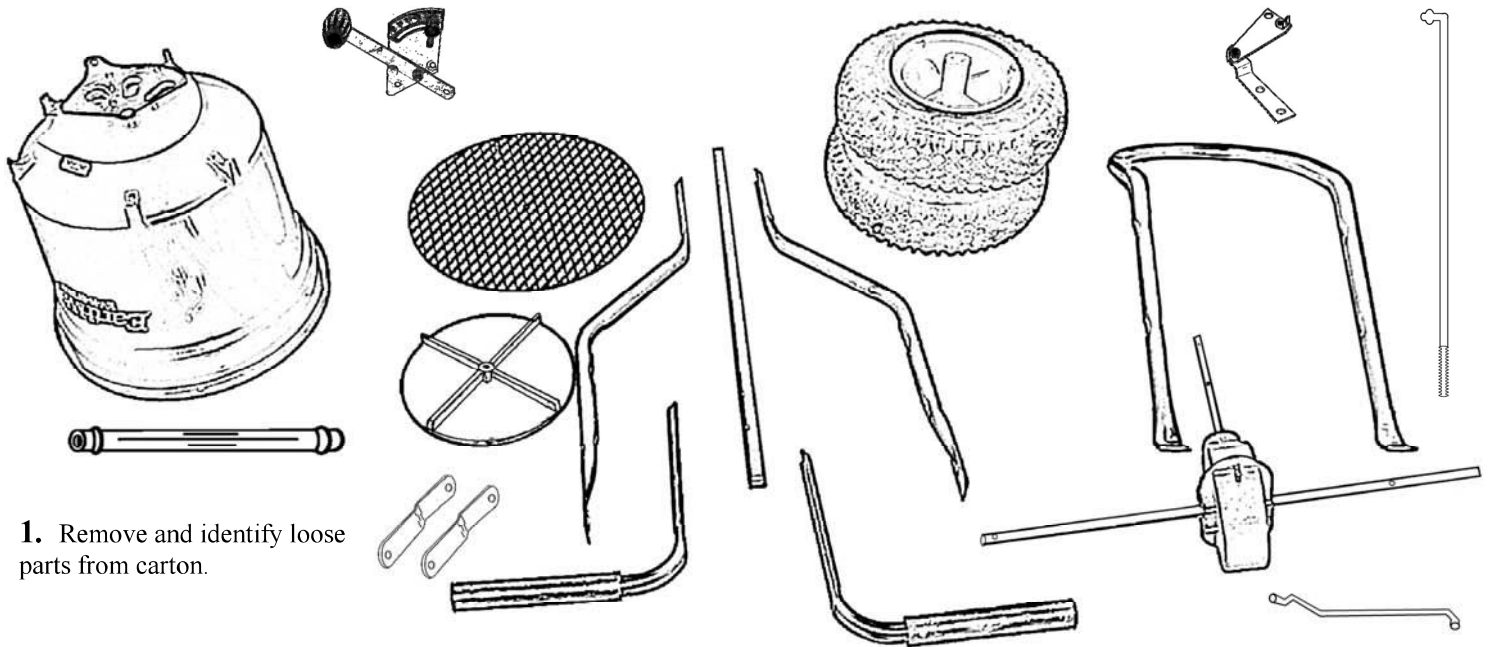

1. Remove and identify loose parts from carton.

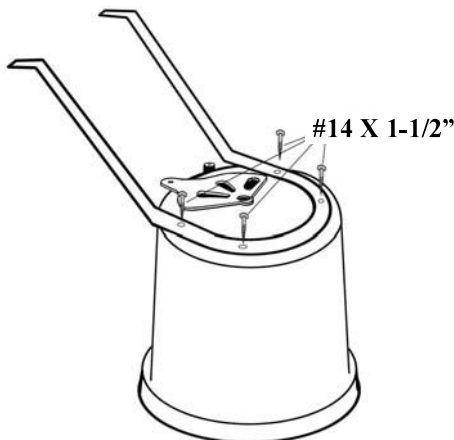

2. Position hopper upside down and install frame using (4) #14 x 1-1/2" flat head Phillips screws.

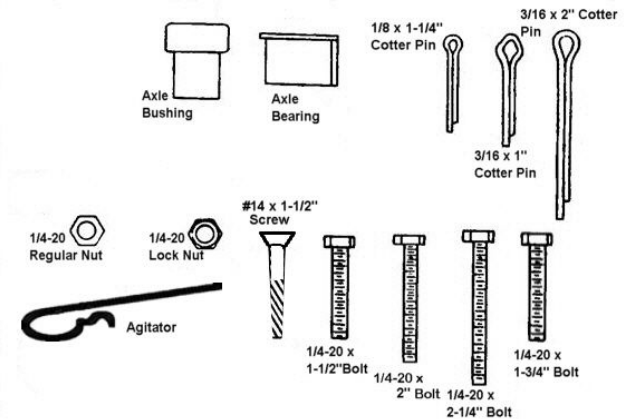

ROCK SALT IS NOT RECOMMENDED FOR USE IN THIS SPREADER. REMOVE AGITATOR WHEN USING ICE MELT.

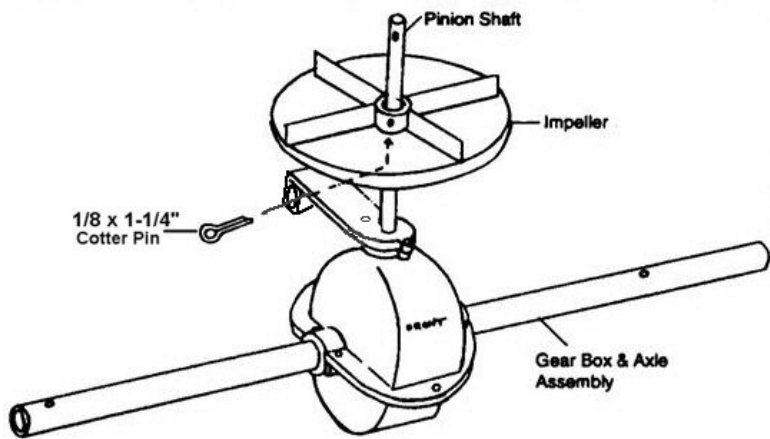

3. Install impeller onto pinion shaft. Insert $\frac{1}{8}$ " x 1- $\frac{1}{4}$ " cotter pin through impeller then through pinion shaft. Use hole closest to the gear box. Spread cotter pin to prevent from falling out.

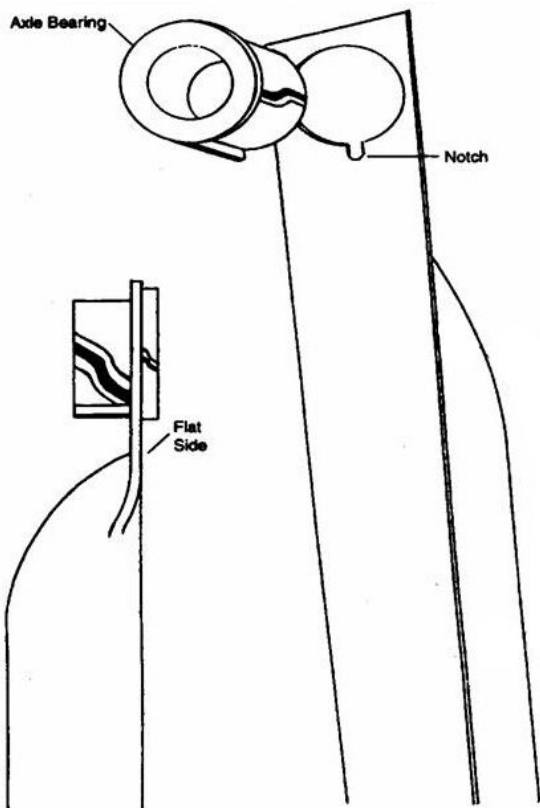

5. Install axle bearings to both lower handles. NOTE: Notch on bearings and lower handles. Bearings must go through flat side of lower handle.

6. **A** - Install lower handles onto axle to both sides as shown. Insert 2 $\frac{1}{4}$ " bolt through second hole in lower handle and through first hole in frame install locknut. **DO NOT TIGHTEN.**

B - Now insert 1 $\frac{1}{2}$ " bolt through first hole in lower handle. Then through frame brace. NOTE: Dimples on frame brace must be facing toward gear box as shown. Next into threaded connector in cross brace. **DO NOT TIGHTEN.**

C - Next insert 1 $\frac{1}{2}$ " bolt through other end of frame brace and through second hole in frame install locknut.

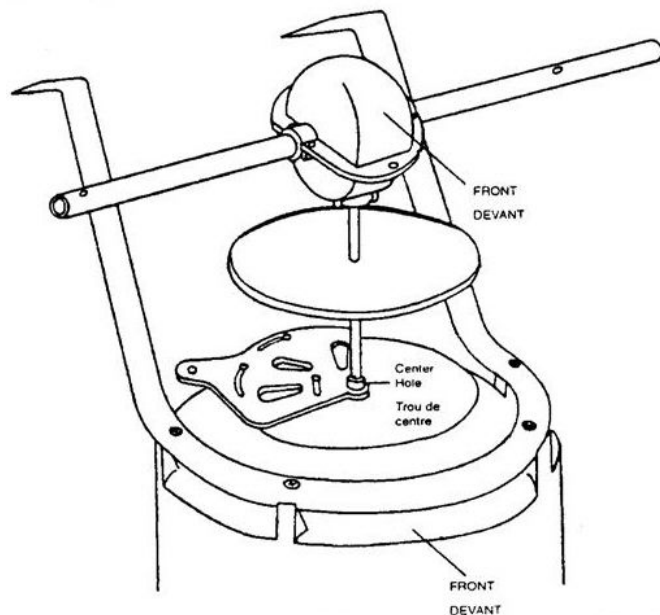

4. Install gear box by inserting the pinion shaft into hole in center of hoppers bottom. The word "FRONT" on the gearbox must point to **Front** of the hopper. Follow label instructions on hopper.

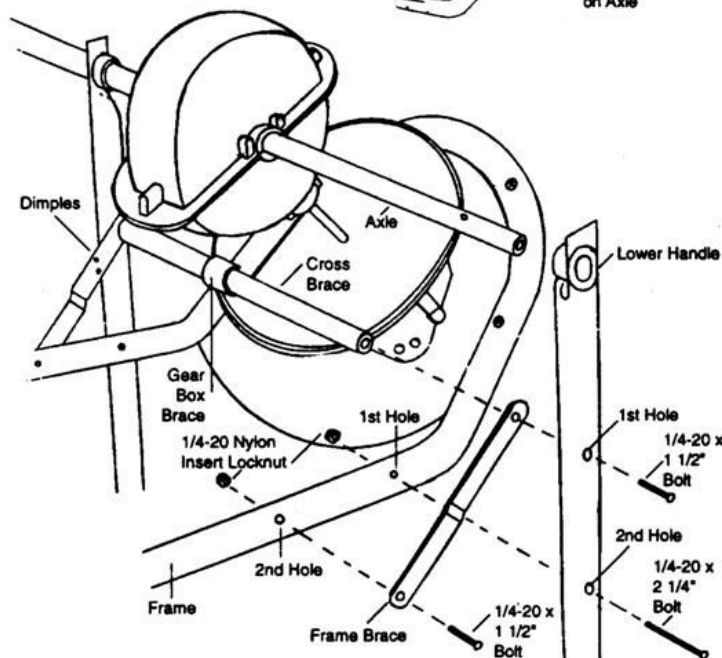
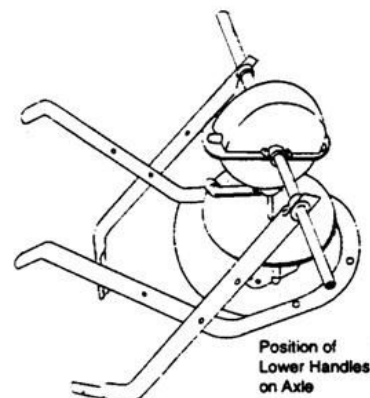

NOW GO BACK AND TIGHTEN ALL NUTS AND BOLTS STARTING WITH FIRST STEP. DO NOT OVER TIGHTEN.

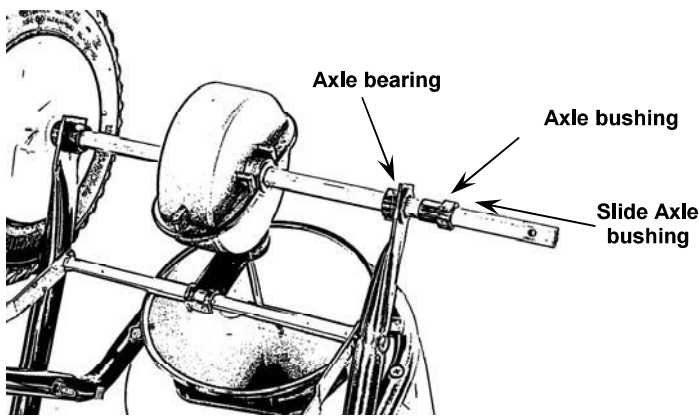

7. Slide axle bushing over axle and into axle bearing to both sides as shown.

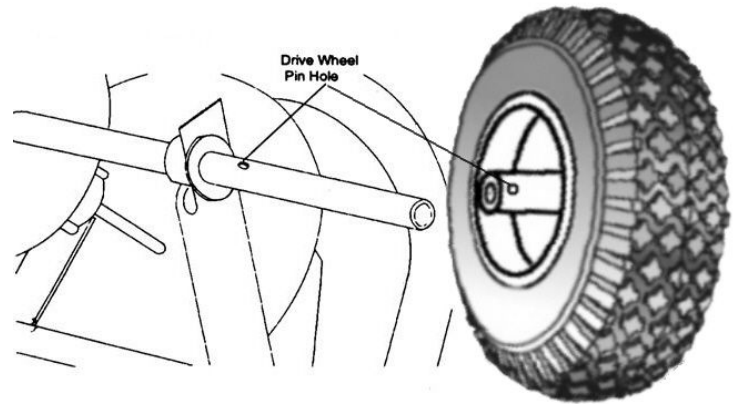

8. Install drive wheel to axle using pin hole nearest to lower handles as shown. Insert 2" cotter pin through wheel and through axle. Bend with pliers to prevent pin from falling out.

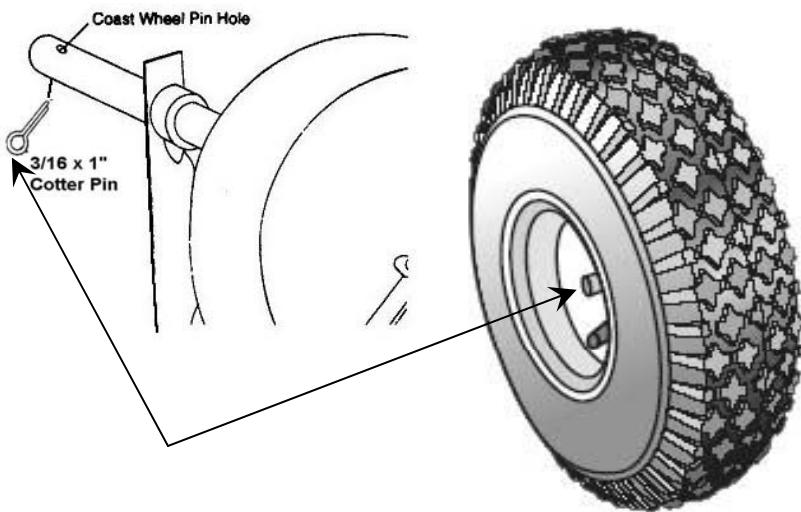

9. Install coast wheel to axle using outside pin hole. As shown, insert 1" cotter pin through axle (not thru the wheel). Bend with pliers to prevent pin from falling out. **TURN SPREADER UPRIGHT ON TO WHEEL.**

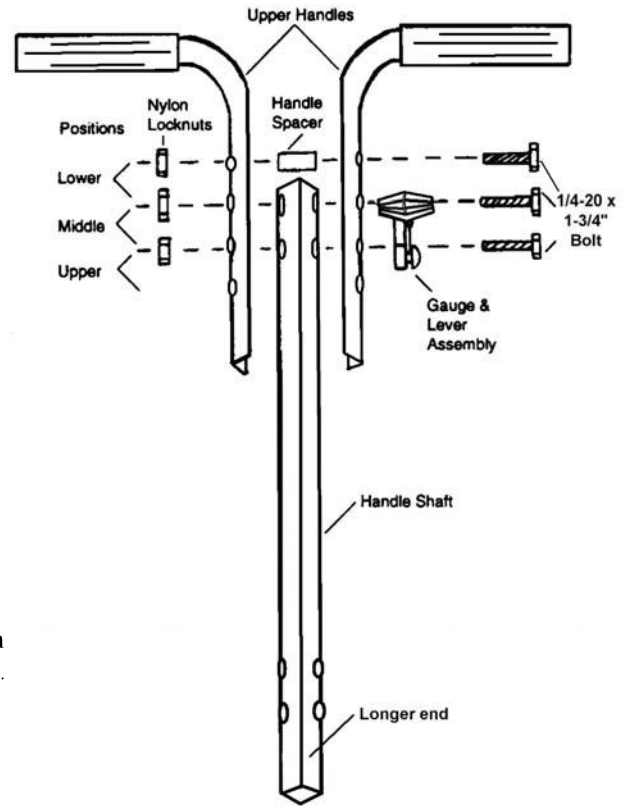

10. NOTE: BEFORE INSTALLING GAUGE AND UPPER HANDLES TO HANDLE SHAFT, UPPER HANDLES FEATURE THREE POSITIONS FOR OPERATOR'S COMFORT. If operator chooses middle or upper positions, use handle spacer in hole nearest to handle grips. Insert 1 3/4" bolt through upper handle, then through handle spacer through other upper handle. **DO NOT TIGHTEN LOCK-NUT YET. TIGHTEN THIS NUT LAST.** Install gauge & lever using (2) 1 3/4" bolts. Be sure gauge is on left hand side. Tighten locknuts to gauge first. **TIGHTEN NOW.**

11. Insert pivot rod into shut off plate as shown. Turn to lock in place.

12. Insert other end of pivot rod into pivot and bracket assembly as shown. Turn to lock in place.

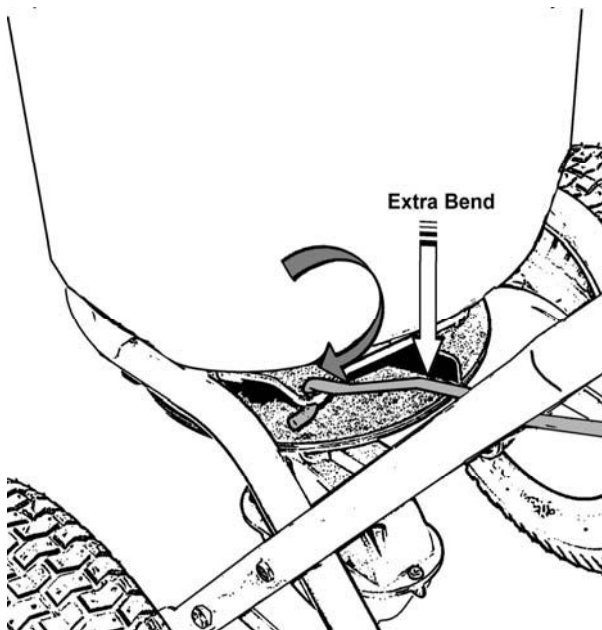

13. Install handle shaft to lower handles and pivot & bracket assembly as shown. Using 1/4-20 x 1-3/4" bolts and lock-nuts.

TIGHTEN BOLTS AND NUTS NOW.

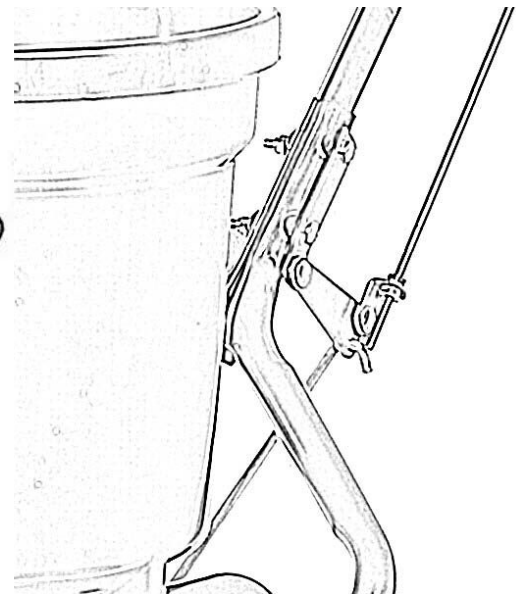
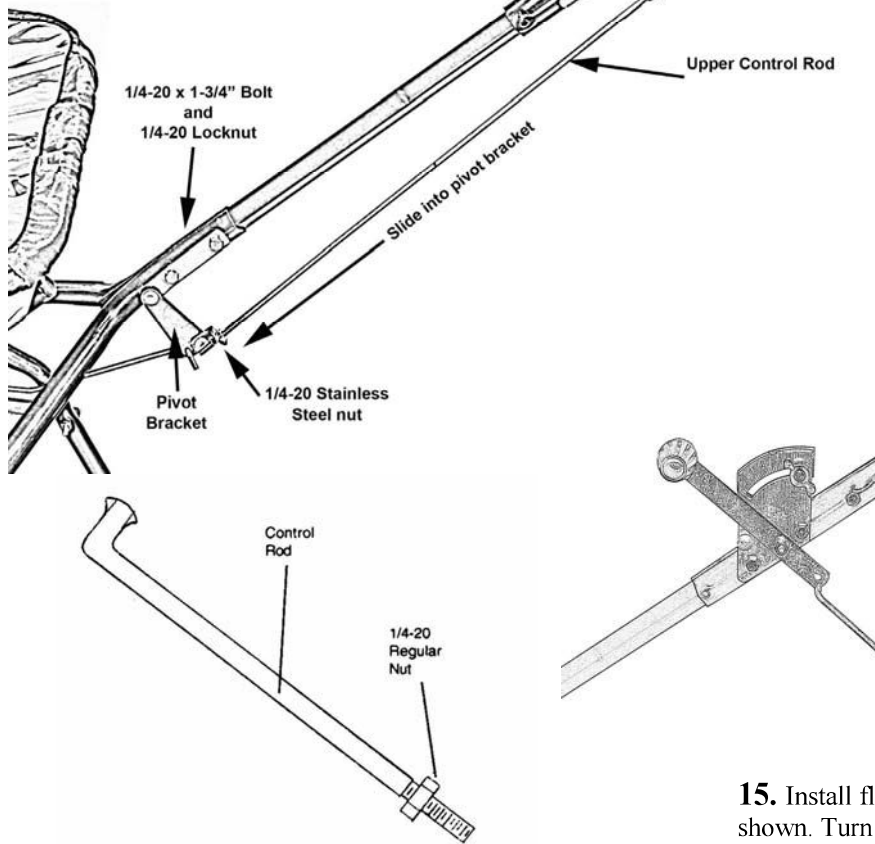

14. Install (1) 1/4-20 regular nut (not a locknut) on to control rod as shown.

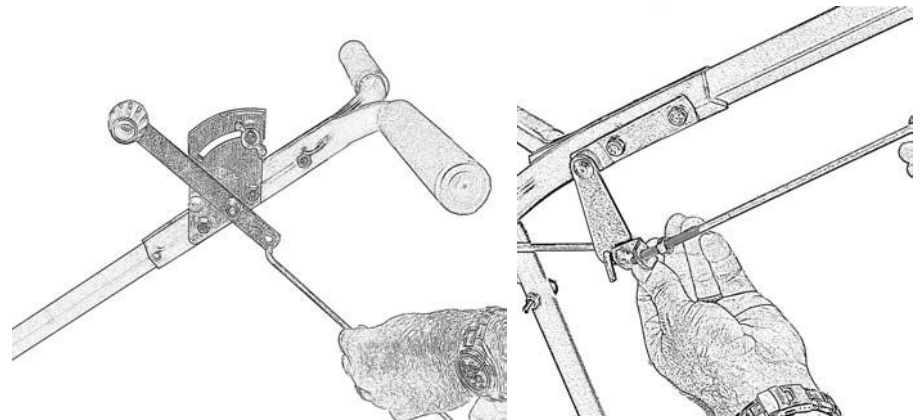

15. Install flattened end of control rod in to lever on gauge as shown. Turn to lock in place. Next push lever forward to setting "0". Align control rod with hole in pivot bracket, pull lever backward to insert control rod through hole in pivot bracket. Now install 1/4-20 regular nut on to control rod.

DO NOT TIGHTEN NUTS YET.

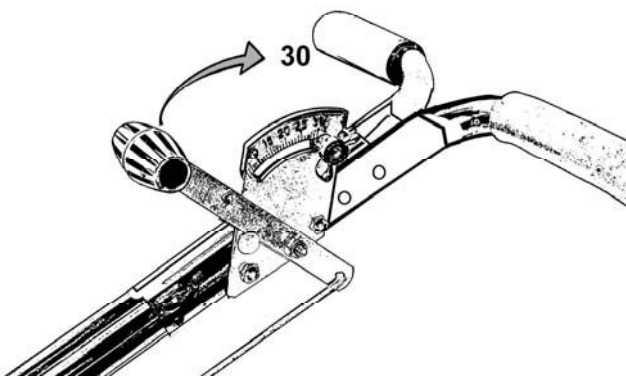

16. Pull lever back to setting "30" as shown. Next push pivot & bracket forward so that the shut off plate in the hopper is in the full open position. **REMEMBER SETTING "30" ON THE FLOW CONTROL LEVER MUST PLACE THE SHUT-OFF PLATE IN THE FULL OPEN POSITION TO BE PROPERLY CALIBRATED.** Now tighten the nuts against the pivot bracket to prevent change in calibration.

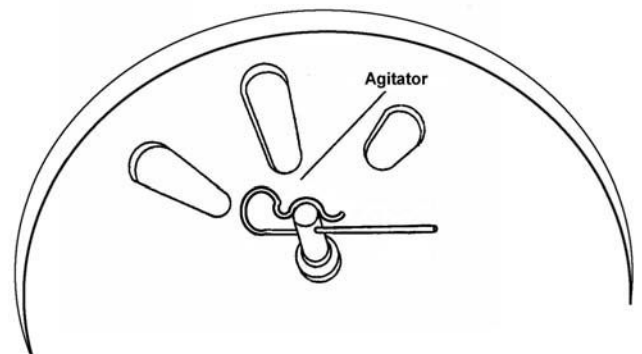

17. Insert agitator to pinion shaft on inside of hopper. **Note:** Position of flat side of agitator. This pin should be installed as shown.

The settings furnished on the Rate Setting Chart are intended as a guide only. Variations in physical characteristics of material applied, walking speed, and roughness of ground surface may require slightly different spreader settings.

Due to the above conditions, EARTHWAY PRODUCTS, INC. makes no warranty as to the uniformity of coverage actually obtained from the settings listed.

WARRANTY

EARTHWAY guarantees this product to be free of defects in original workmanship and materials for a period of 90-days from sale to the original user. If any defect develops during this period EARTHWAY will repair or replace this product at no charge provided the defect is not the result of mishandling or tampering and that this product is received at the factory with shipping charges prepaid. For quicker service you may call EARTHWAY at **574-848-7491** or write and describe the nature of the defect and we will send repair parts to you. Due to the corrosive nature of most fertilizers and ice melters, EARTHWAY PRODUCTS, INC. makes no warranty or guarantee against corrosion failure on models with plated steel or painted steel frames. Clean and dry your spreader thoroughly after each use. Warranty covers parts only, not any labor charges to repair or replace those parts.

DO NOT RETURN TO DEALER FOR REPAIR

EARTHWAY PRODUCTS, INC.
1009 Maple Street
P.O. Box 547
Bristol, IN 46507

FOR YOUR RECORDS

Date Purchased

Store Name

HOW TO ORDER SPARE PARTS

All spare parts listed herein may be ordered direct from the manufacturer, **EARTHWAY PRODUCTS, INC.** Be sure to give the following information when ordering.

- 1. Model Number**
- 2. Part Number**
- 3. Part Description**

Call (574) 848-7491 or 800-294-0671 or write for current prices.

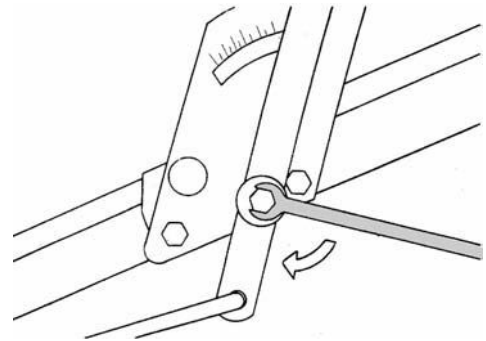

18. Tension on the flow control lever may be adjusted by tightening or loosening the tension nut as shown.

OPERATING INSTRUCTIONS

Before filling hopper, become familiar with the operation of this spreader.

- * Obtain proper setting for material to be used from the RATE SETTING CHART included with this spreader.
- * Move stop bolt on rate gauge assembly to the proper setting.
- * While pushing spreader forward, pull control lever back to stop bolt.
- * To stop, push lever forward to close flow holes before you stop moving.
- * When finished, empty any remaining material from hopper.
- * Thoroughly wash spreader and allow to dry before storing. No oiling is necessary.
- * Remove agitator when using Rock Salt to prevent gearbox damage.

OPTIMUM SPREADING PATTERN

FULL RATE SETTINGS

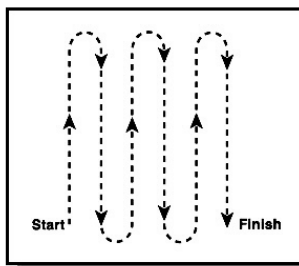

HALF RATE SETTINGS

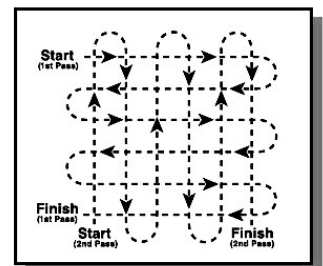

EarthWay®

Products, Inc.

P.O. Box 547
 Bristol, Indiana 46507
 (574) 848-7491
 www.earthway.com

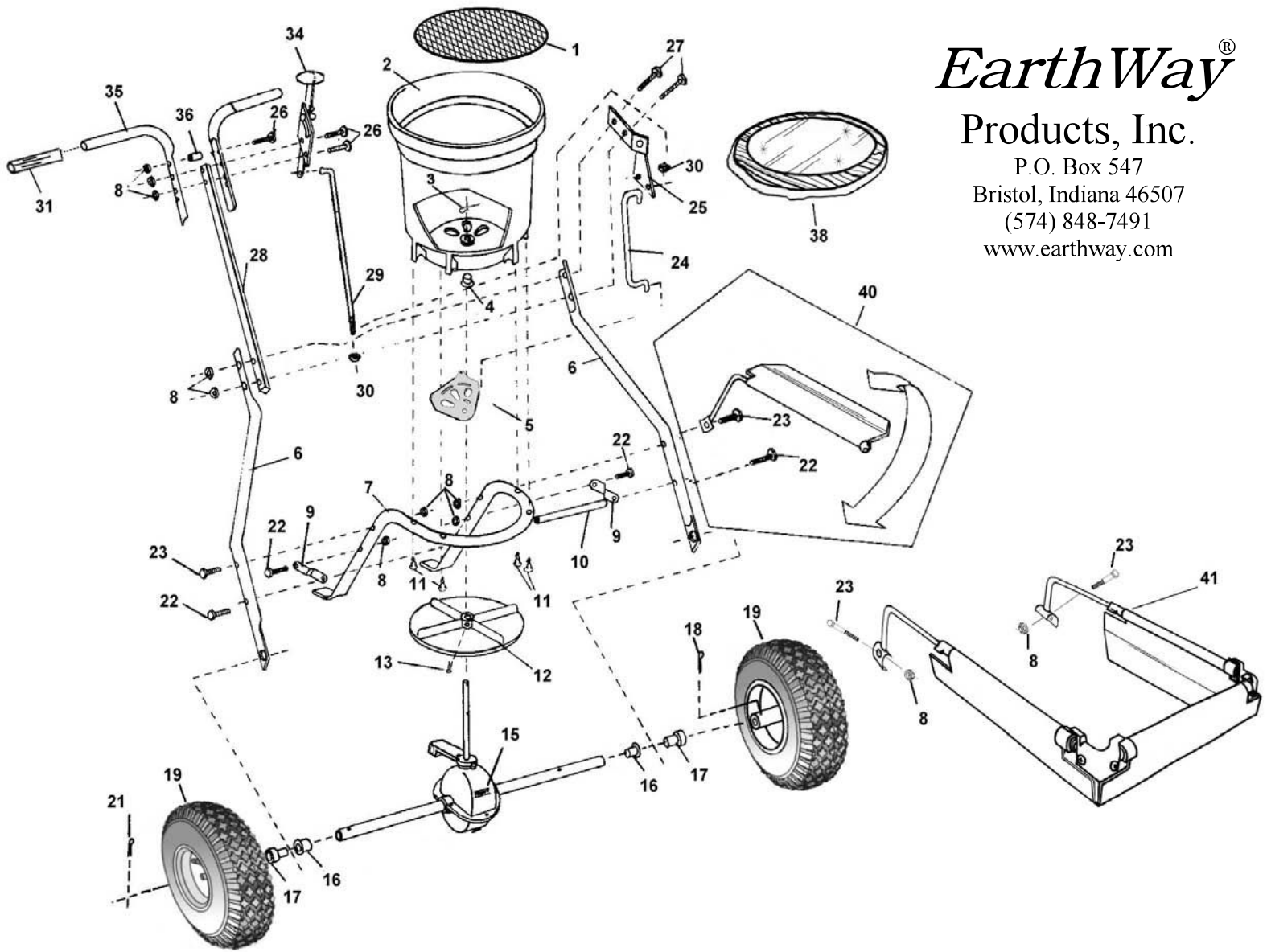

2150 Parts List

Key #	Part #	Description	Key #	Part #	Description
1	40002	Screen	21	33108	3/16" X 1" Cotter Pin
2	60332	Hopper Assembly, Includes Key #4 & 5	22	31100	1/4-20 X 1 1/2" Bolt
3	33117	Agitator	23	31106	1/4-20 X 2 1/4" Bolt
4	12220	Hopper Bushing	24	44251	Pivot Rod
5	12317	Shut Off Plate	25	60300	Pivot & Bracket Assembly
6	25222	Lower Handle	26	31114	1/4-20 X 1-3/4" Bolt
7	25106	Frame	27	31120	1/4-20 X 2" Bolt
8	32103	1/4-20 Nylon Locknut	28	25223	Handle Shaft
9	44249	Frame Brace	29	42256	Control Rod
10	24704	Cross Brace	30	32100	1/4-20 Hex Nut
11	31104	#14 X 1 1/2" Flat Head Screw	31	12274	Handle Grip
12	12109	Impeller	34	60298	Gauge & Lever Assembly
13	36105	1/8" X 1" Cotter Pin	35	60175	Upper Handle, Includes Grip
15	60333	Gear Box & Axle Assembly	36	12344	Square Handle Spacer
16	12148	Axle Bearing	38	77001	Optional Heavy Duty Rain Cover
17	12152	Axle Bushing	40	60043R	Optional Heavy Duty Rain Cover & Side Deflector Kit
18	33109	3/16" X 2" Cotter Pin Stainless Steel	41	60166R	Optional Salt Deflector Kit
19	70138	Drive Wheel/Coast Wheel		38075	Hardware Package

Nuts & bolts are available at most local hardware stores